



Smart thermostat with built-in Zigbee hub for European heating system



## The TIDE Climate Control Family introduces TIDE Dial, a white label smart thermostat with a built-in Zigbee hub for European central heating systems

UEI's new thermostat, TIDE Dial, is designed for HVAC OEM, hospitality-branded, home automation, and energy management applications. Featuring the QuickSet Widget, it offers native cloud connectivity, device management, and lifecycle support services. TIDE Dial comes with TIDE Bridge which connects to the boiler system and communicates wirelessly to the TIDE Dial, giving you the choice to put the TIDE Dial wherever you want.

In addition to Wi-Fi connectivity, TIDE Dial concurrently operates as a Zigbee gateway that can be used to add external sensors or TRVs for smarter climate control.

### QuickSet Cloud Services

- QuickSet enables device discovery and control of 3rd party external sensors and IAQ devices
- Device management dashboard for analytics, service maintenance & support
- Flexible to customize & time to market

### Virtual Agent by nevo.ai

- Self-help support for device discovery, auto-setup & troubleshooting
- Virtual Agent guides DIY users through step-by-step wiring instructions, physical installation, and Wi-Fi onboarding

### Product USPs



Multi-sensor capability



Wall mount and tabletop variants



Virtual Agent

# Features

## Use Cases

### Multizone

TIDE Dial & tabletop adaptor + TIDE Bridge to boiler system + Radiator TRV  
+ TIDE Temperature Humidity Sensor

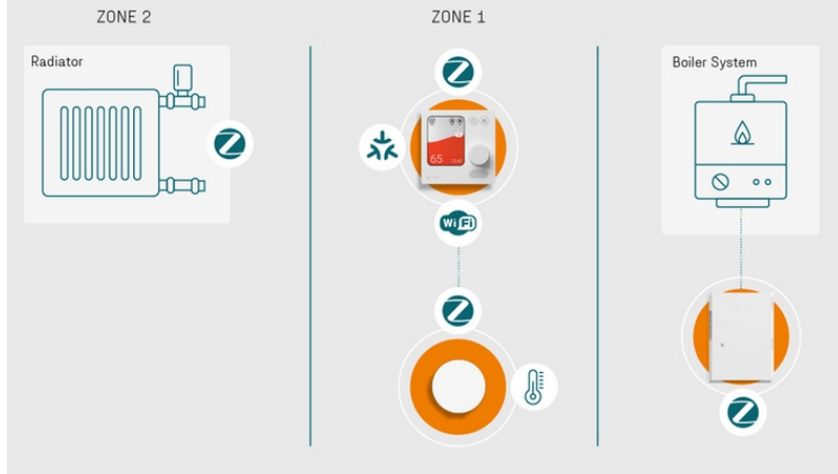

QUICKSET®



# Specifications

## Model

- Model name: TIDE Dial
- Model number: EU24 (wall mount), EUUSB (tabletop)
- Product dimensions MM (LxWxH): 86x86x23.3

- Model name: Tide Bridge
- Model number: EU230
- Product dimensions MM (LxWxH): 86x86x44.5

## Display

- Display: 2.8" 262k Full Dot Matrix TFT IPS screen
- Display resolution: 240x320 pixel
- Pixel density: 141 dpi

## Connectivity

- Protocols: TIDE Dial:
  - Wi-Fi: 2.4 GHz, 802.11b/g/n
  - Bluetooth Low Energy BLE, 5.0
  - Zigbee 3.0 (Coordinator)
  - Matter over Wi-Fi
- Protocols: TIDE Bridge: Zigbee 3.0 (Router)

## Power

- Voltage: TIDE Dial
  - Wallmount Variant: 24VDC power from TIDE Bridge
  - Tabletop Variant: Comes with AC adapter, USB C cable, and tabletop stand in the box
- Voltage: TIDE Bridge: 230VAC

## HVAC System Compatibility

- Supported equipment: Combi- and condensing boilers, System- and heat-only boilers, On/Off and OpenTherm systems, Hydronic underfloor systems
- Supported combi boiler: Combi SL, Combi AB, S Plan, Y Plan
- Supported fuel: Gas, oil and electric

## Sensors

- Temperature sensor (Onboard)
- Humidity sensor (Onboard)
- Occupancy / proximity sensor (Onboard)
- CO2 sensor (Onboard) (optional)